

# Three Coat Stucco at Bottom of Wall With Sure Cavity Stucco Lath<sup>®</sup>

Sure Cavity Stucco Lath<sup>®</sup> (SCSL 3230) and Corrugated Lath Starter Strip<sup>™</sup> (CLSS 2316)  
and L & R Weep Screed<sup>™</sup> (LR 3501)

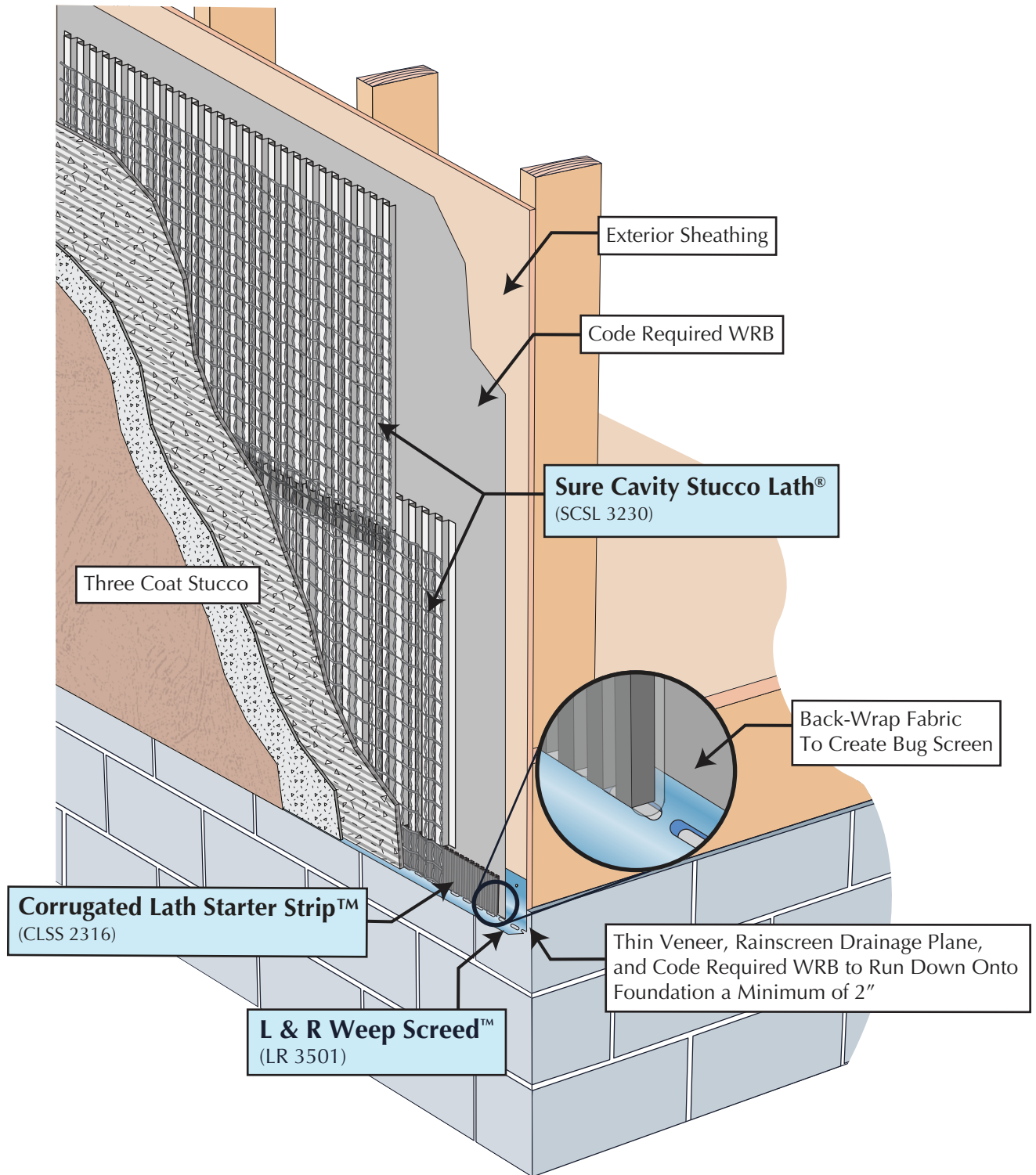

Copyright © 9/26/24 Masonry Technology Incorporated, All Righth Reserved.

MTI details are created from sources deemed to be reliable. However, MTI does not guarantee the accuracy or completeness of any information, nor shall be held responsible for any errors, omissions, or damages arising out of the use of this information. These details are created with the understanding that MTI is providing information but is not attempting to render engineering or other professional service. If such services are required, the assistance of an appropriate profession should be sought. Use MTI materials in strict conformance with local building codes and regulations. Consult local code/code officials prior to installation. It is the buyer's responsibility to ensure that MTI materials are used in strict conformance with local building codes and regulations.