

Prevents Mortar Build-Up in The Bottom of CMU Cores



Applications

- ✔ Single Wythe CMU Walls
- ✔ CMU Veneers

Mortar Belt is a no-fuss solution to prevent trash mortar accumulation on weeps in block cores

Ensuring A Drainage Path in CMU Cores

Keep your weeps working well by keeping a clear path for drainage in CMU cores with Mortar Belt. Mortar Belt rolls out quickly on top of masonry units and holds trash mortar squeezings away from weeps. Mortar Belt keeps your walls draining and crew working efficiently.

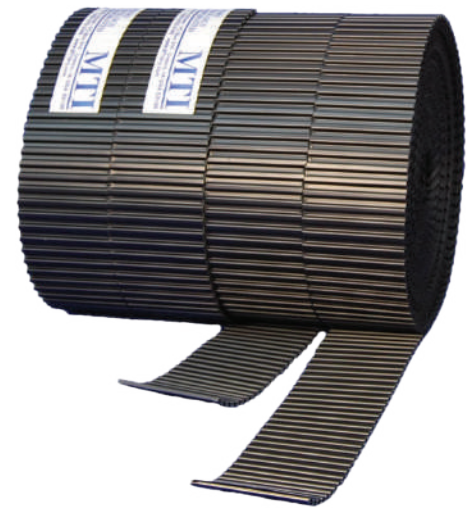

Mortar Belt bundles contain four 50 ft rolls

The MTI Advantage

- ✔ Catches & Holds Trash Mortar
- ✔ Protects Drainage Path to Weeps
- ✔ Easy to Install
- ✔ 100% Recycled Content



Mortar Belt installed in center of CMUs

Installation

- Center Mortar Belt™ on CMU wall every 4 to 6 courses
- Caution - Mortar Belt should only be used with masonry unit cells that are at least 5" wide

Complete Installation at MTIdry.com/installation

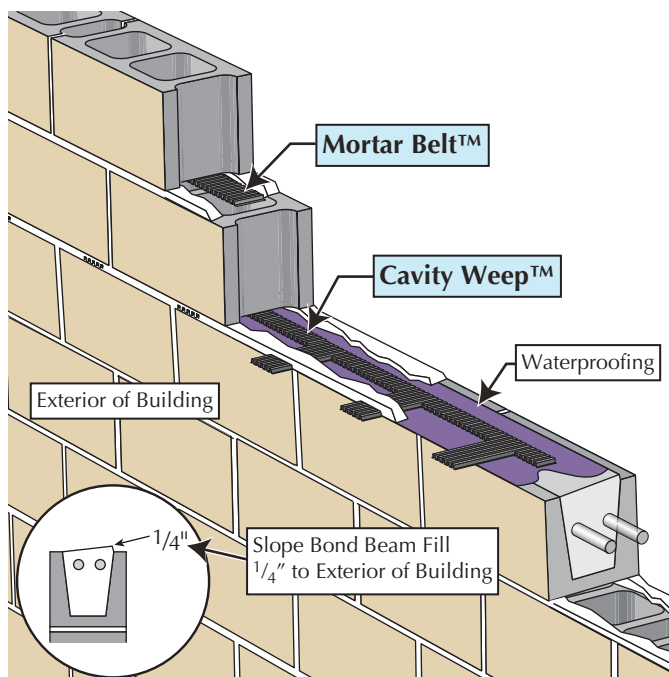

Technical Information

Material Description Corrugated plastic made of 0.6 mm pre-consumer recycled high-impact polystyrene .

Mortar Belt MB 3550

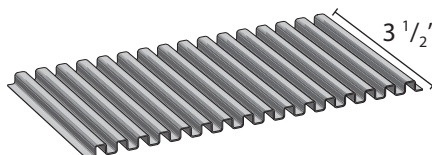
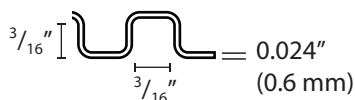

Related Products:

- Cavity Weep™
- Vent Mat™

Roll	50 ft
Bundle	200 ft / 4 rolls
Box	800 ft / 4 bundles

Questions about application, installation or ordering?
MTIdry.com/mortar-belt