

Full Stone Veneer Run-To-Grade on CMU Backup Wall with Rigid Insulation at Prestressed Concrete Floor Transition

Bottom Detail

Sure Cavity™ (SC 5016) or 10mm Sure Cavity™ (SCMM 2516) or Gravity Cavity™ (GC 1816) and Wall Opening Weeps™ (WOW 9095) and Mortar Belt™ (MB 3550)

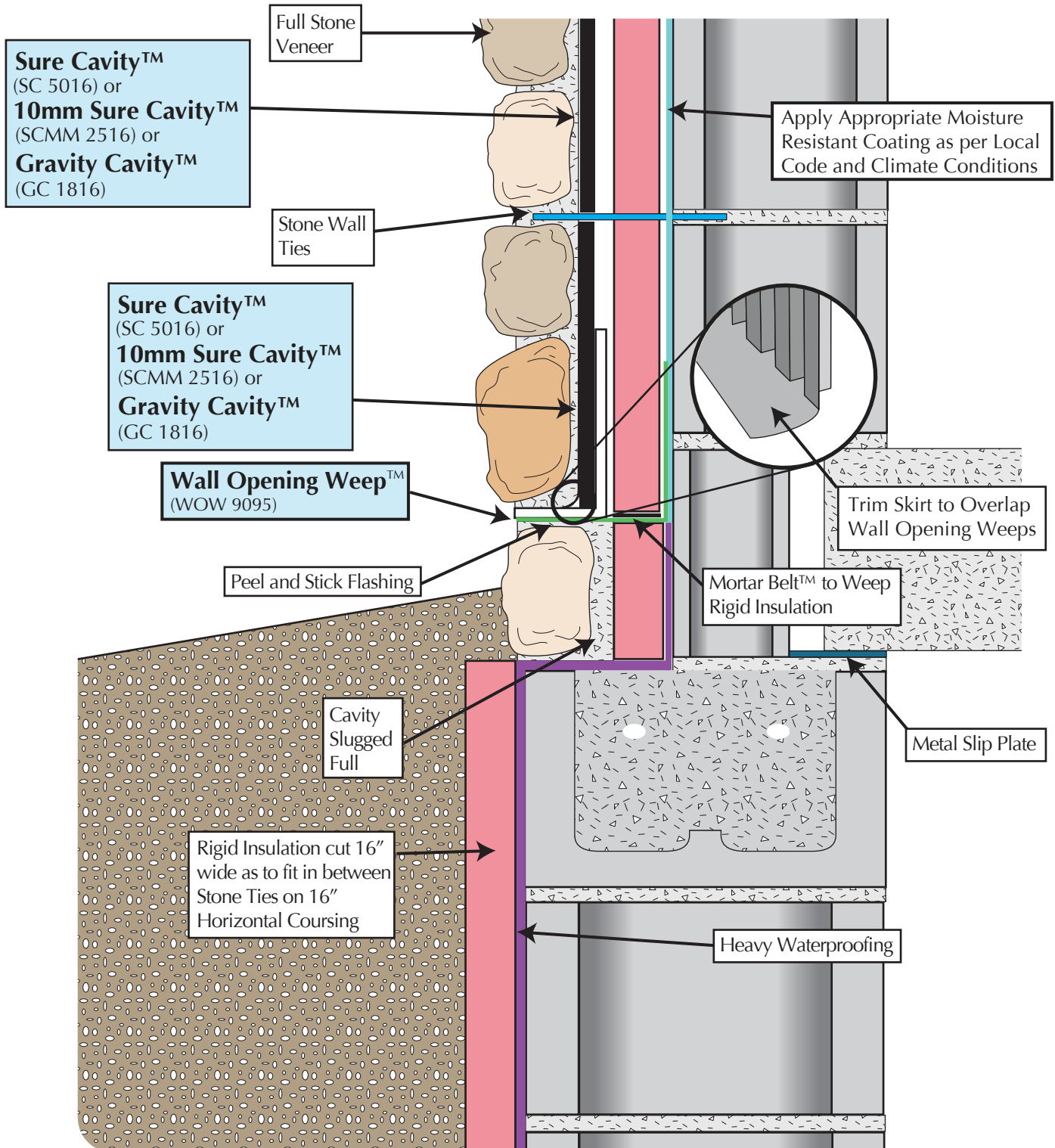

Copyright © Masonry Technology Incorporated, 12/2009, All Rights Reserved.

06FR10BW003

MTI CAD drawings are created from sources deemed to be reliable. However, MTI does not guarantee the accuracy or completeness of any information, nor shall be held responsible for any errors, omissions, or damages arising out of the use of this information. These drawings are created with the understanding that MTI is providing information but is not attempting to render engineering or other professional service. If such services are required, the assistance of an appropriate profession should be sought. Use MTI materials in strict conformance with local building codes and regulations. Consult local code/code officials prior to installation. It is the buyer's responsibility to ensure that MTI materials are used in strict conformance with local building codes and regulations.