

Three Coat Stucco Installed on Wood Stud Backup Wall with Vented Parapet Coping

Sure Cavity™ (SC 5016 or SC 5032) or Gravity Cavity™ (GC 1816 or GC 1832)

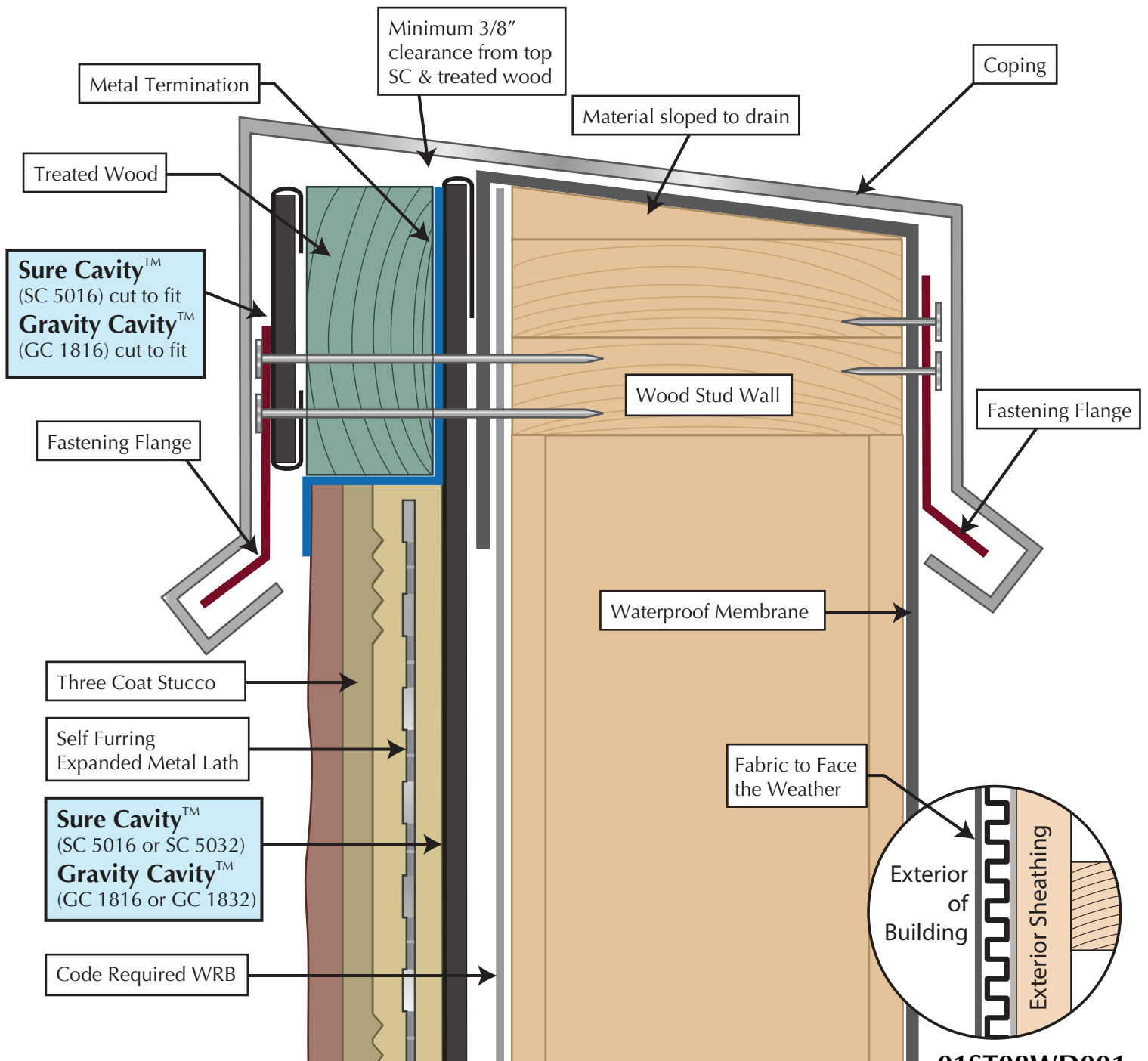

01ST08WD001

Copyright © 2016 Masonry Technology Incorporated, All Rights Reserved.

MTI details are created from sources deemed to be reliable. However, MTI does not guarantee the accuracy or completeness of any information, nor shall be held responsible for any errors, omissions, or damages arising out of the use of this information. These details are created with the understanding that MTI is providing information but is not attempting to render engineering or other professional service. If such services are required, the assistance of an appropriate profession should be sought. Use MTI materials in strict conformance with local building codes and regulations. Consult local code/code officials prior to installation. It is the buyer's responsibility to ensure that MTI materials are used in strict conformance with local building codes and regulations.

5/4/2023